

# STELTEC

Make your home  
Safe, stable and smart

## Energy Storage Battery LV Series

[www.steltec-ess.com](http://www.steltec-ess.com)  
[sales@steltec-ess.com](mailto:sales@steltec-ess.com)

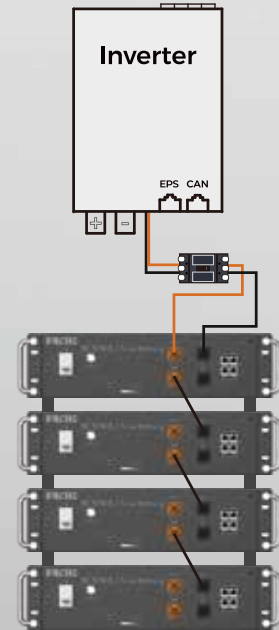

Basic-L1

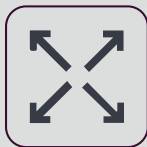

**Flexible Investing**  
Expandable to 5.22-78.3kWh



**10 Years  
product warranty**



**1C discharge  
and charge rate**



**Safe & Reliable**  
Lithium Battery (LFP)



**Intelligent Build in BMS**  
Monitored for 24\*7



**Easy Installation**  
Only 46kg/pcs  
Plug and Play

(Unit:mm)

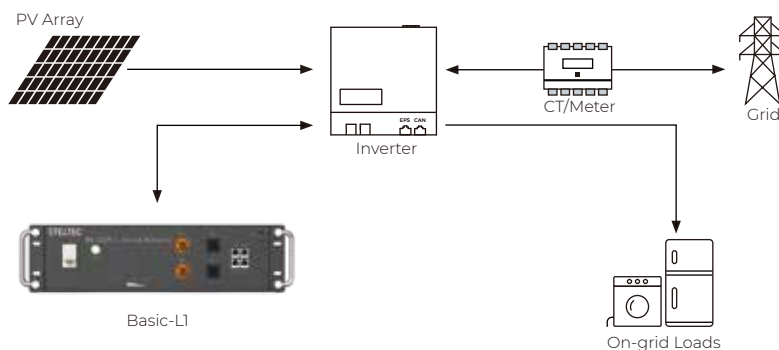
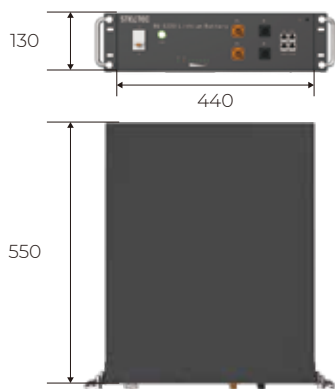

# STELTEC

Product type	Basic-L1
Technical specification	
Battery model	BU 5220
Battery System Capacity	5.22kWh
Cell Technology	Li-ion(LFP)
Battery Cell Capacity	102Ah
Configuration	1P16S
Nominal Voltage	51.2V
Operating Voltage Range	45.6~56.2V
Dimension (W*D*H)	440*550*130(mm) / 17.32*21.65*5.12(inch)
Net Weight	46 kg (101.41 lb)
Scalability	Max. 15 systems in parallel operation
Installation	Floor stand (standard) , Wall mounted (optional)
Depth of Discharge	90%
Battery System Charge Current (Normal)	80A
Battery System Charge Current (Max)	100A
Battery System Discharge Current (Normal)	80A
Battery System Discharge Current (Max)	100A
Cooling	Natural convection
Communication Port	RS232, RS485, CAN
Protection Class	IP20
Operating Temperature	0°C~50°C (32°F~122°F)
Shelf Temperature	-20°C~50°C (-4°F~122°F)
Humidity	5%-95%
Max. operating altitude	2000m (6,562ft.)
Operation Life	10 years
Standard Compliance (more available upon request)	
Certificates	IEC62619 / IEC61000 / IEC62040 / CE / UN38.3